

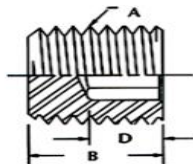

MANUFACTURERS OF PIPE FITTINGS

316 STAINLESS STEEL HEX SOCKET PIPE PLUGS

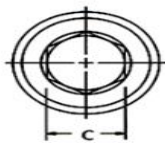

A - NPTF THREAD	B - BODY LENGTH, MIN.	C - HEX WIDTH, NOM.	D - SOCKET DEPTH, MIN.
1/16 - 27	.290	0.1562	0.120
1/8 - 27	.290	0.1875	0.120
1/4 - 18	.445	0.25	0.190
3/8 - 18	.445	0.3125	0.190
1/2 - 14	.590	0.375	0.250
3/4 - 14	.630	0.5625	0.310
1 - 11 1/2	.750	0.625	0.380
1 1/4 - 11 1/2	.80	0.75	0.380
1 1/2 - 11 1/2	.83	1	0.406
2 - 11 1/2	.88	1	0.406

MADE IN U.S.A.

Billco Corporation

770 W. Belden Ave. Addison, IL 60101

Ph: (630) 543- 4777

www.billcocorp.com